



Dear Potential Mississippi Fruit and Vegetable Growers Conference and Trade Show Exhibitor:

Mark your calendar! This is one opportunity that you will not want to miss!

***Mississippi Fruit & Vegetable Growers Conference & Trade Show
in conjunction with
Mississippi Agritourism & Gulf South Blueberry Growers Associations
November 14-16, 2011
Vicksburg Convention Center, Vicksburg, Mississippi***

The Mississippi Fruit and Vegetable Growers Association is pleased to announce that we will be hosting the Mississippi Fruit and Vegetable Growers Conference in conjunction with the Mississippi Agritourism Association and the Gulf South Blueberry Growers Association. The date has been moved up to November in order to better accommodate growers and exhibitors. This event will feature educational programs based on a variety of topics that are important to fruit and vegetable growers along with a trade show. All of which will be held at the Vicksburg Convention Center.

Some topics for the Fall 2011 Conference include but are subject to change:

- General and Production Sessions: Soil Building, Cover Crops, Marketing, Deer Control, Figs, Blackberries, Peaches, Apples, Mushrooms, Muscadines, Advanced Melon Production, Tomatoes, Diverse Greens, Cabbage, Cauliflower, Niche Veggies, Post Harvest, Pest and Disease Updates, etc.
- Organic Sessions: Pollination, Biofumigation, Farmscaping for Bug Control, Record Keeping, Organic, Composting, etc.
- Blueberry Sessions
- Agritourism Sessions

Workshops include: Insurance, Strawberries, and Plastic Mulch Laying

You are invited to participate as an exhibitor in the trade show. Your participation will allow you to network with fruit and vegetable growers and agritourism operators, promote your companies' products and services, and display equipment. Growers have told us that the trade show is an important part of the Conference. They also appreciate the opportunity to purchase items at the trade show, so be sure to bring items to sell. Time will be allotted during, before and after classes for the growers to visit you at your booth.

Exhibitors will be allowed to set up exhibits from 10:00 a.m. – 2:00 p.m. on Monday, November 14. The trade show opens at 3:00 p.m. on Monday and an exhibitor reception will be from 5:00 – 7:00 p.m. on Monday evening in the trade show area. The reception will be a kick off to the conference and will include hors d'oeuvres featuring Mississippi grown produce. Lunch will be served in the trade show area on Tuesday and is included with each paid attendee for your booth. The trade show will close at 12:00 p.m. on Wednesday, November 16th. Exhibitors will need to be out of the exhibit hall by 2:00 p.m. on Wednesday.

We will be holding a silent auction during the Conference. The proceeds from the auction will benefit a newly created Mississippi Fruit & Vegetable Growers Association College Scholarship Fund. If you are interested in donating an item to the silent auction, please let us know by indicating on the registration form.

Booths include 8 ft tall back drapes, 3 ft tall side dividers, one exhibiting company name ID sign, one 6 ft skirted display table, wastebasket and two chairs. Registration for two company representatives is included with each paid booth. Please contact us if you plan would like to bring large equipment. Please contact us early, so the proper booth space and location can be reserved.

Enclosed is an exhibitor registration form, please return the form and a check to me at your earliest convenience, to guarantee your space. *You may also pay with a credit card by calling 601-955-9298.* Space for large equipment is extremely limited, so get your form and money in early to reserve your spot. **Final cutoff for exhibitor registration is October 15, 2011.** Payment in full must accompany registration form. Full Refund (minus 25% processing fee) for cancellations prior to 10-28-2011. No refunds after 10-28-2011.

Please check our website at www.msfruitandveg.com for an updated trade show booth layout. This will be updated regularly with booth reservations.

Please send your registration to:

MFVGA
Attn: Teri McCarter
143 Countryside Cove
Madison, MS 39110

If you have any questions you may contact:

Teri McCarter at 601-955-9298 or through email: info@msfruitandveg.com.

Vicksburg is an easy 45 minute (all interstate) drive from the Jackson, MS airport.

The hotels listed below have special rates for the conference (rooms starting at \$59.00). Please see hotel websites for directions and amenities.

Rate is good for rooms booked before Oct. 15, 2011. A list of additional hotels is available on our website at www.msfruitandveg.com.

Rainbow Hotel Casino (use code MFVGA)

1350 Warrenton Road
Vicksburg, MS
601-638-7111
www.rainbowhotelcasino.com

River Walk Casino Hotel (use code MSFV11)

1046 Warrenton Road
Vicksburg, MS
601-634-0100
www.riverwalkvicksburg.com

We are looking forward to a successful conference, and we hope to see you in Vicksburg.

Sincerely,



Teri McCarter
Secretary/Treasurer
Mississippi Fruit & Vegetable Growers Association



**MISSISSIPPI FRUIT & VEGETABLE GROWERS
CONFERENCE & TRADE SHOW**



**VICKSBURG, MS
NOVEMBER 14-16, 2011**



FALL 2011 EXHIBITOR REGISTRATION

Company _____

Website _____ Contact _____

Products to Exhibit or Sale _____

Mailing Address _____

City _____ State _____ Zip _____

Email _____ Phone _____

Person(s) Attending 1. _____ 2. _____

3. _____ 4. _____

Please choose a booth location(number) and 2 alternate locations (see back for trade show layout):

1. _____ 2. _____ 3. _____

Item Description	Quantity	Amount	Total
8x10 Standard Booth includes 2 attendees		\$400	
8x10 Prime Booth includes 2 attendees		\$450	SOLD OUT
Additional Attendees over the 2 included		\$40	
Electricity Needed		\$45	
Program Advertising and Sponsorship Opportunities: <i>Not available after October 15, 2011.</i>			
Color Full Page Back Cover		\$600	
Color Full Page Inside		\$300	
Color Half Page Inside		\$150	
Color Quarter Page Inside		\$125	
(circle one) Lunch or Break Sponsor (Includes 11x17 Signage on Food Table)		\$250	
(Call 601-955-9298 if you would like to pay by credit card)		TOTAL AMOUNT DUE	\$

I will donate _____ for the silent auction.

**Check Payable to:
MS Fruit & Vegetable Growers Association**

Mail this form and your check to:
Teri McCarter (MFVGA)
143 Countryside Cove
Madison, MS 39110

If you have any questions call Teri McCarter at (601) 955-9298 or email info@msfruitandveg.com.

Payment in full must accompany registration form.

Full Refund (minus 25% processing fee) for cancellations prior to 10-28-2011. No refunds after 10-28-2011.

Vicksburg Convention Center - First Level Floorplan

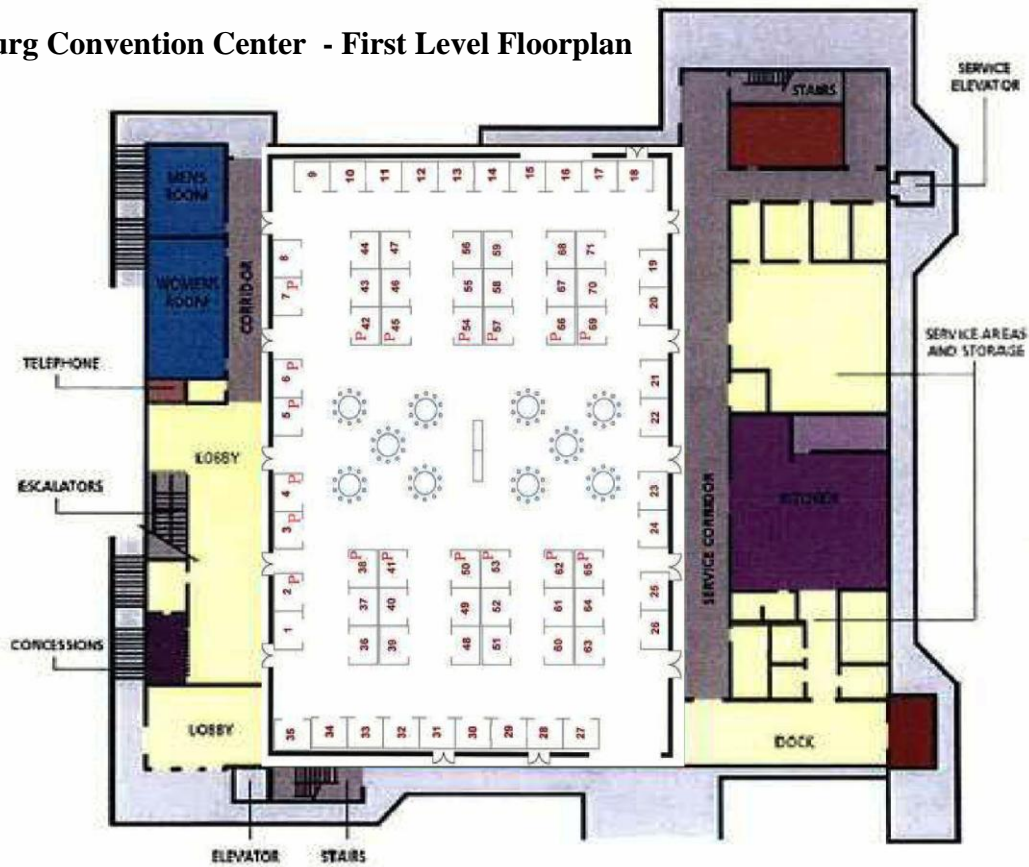

Choose your booth number(s) below. Check our website at www.msfruitandveg.com for a regularly updated layout of reserved booths.

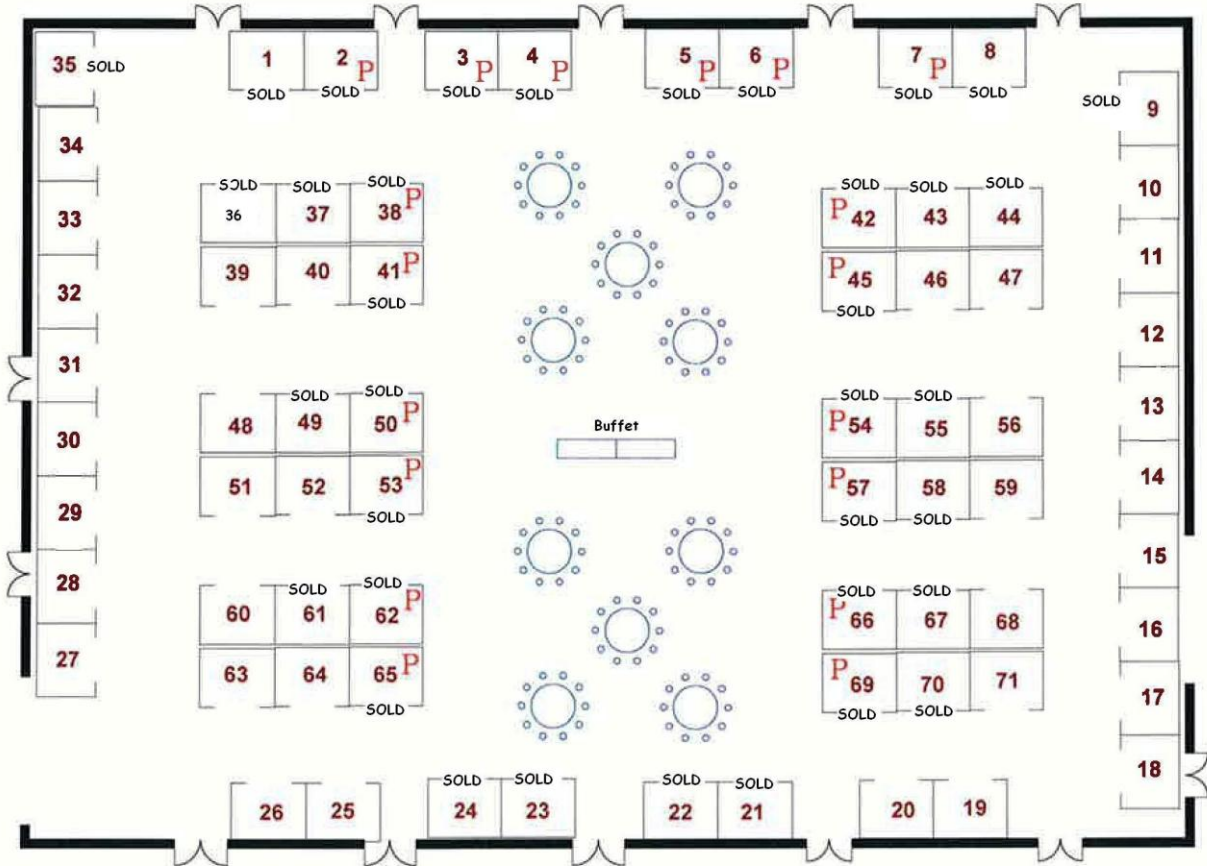

P=Prime Location